

Plug Valves



Specifications

Nominal Size : 1" ~ 4"

Temperature Rating : -29℃ ~ 121℃ (PU) -46℃ ~ 121℃ (LU)

Service : Standard, Sour Gas

Manufacturing standard : API 6A & NACE MR0175

Descriptions

SLETPETRO plug valves are composed of the valve body, dual seals, plug and other components. Plug valves are indispensable important components of well fracturing and cementing. SLETPETRO plug valves feature with compact structure, easy maintenance, lower torque and open quickly. To satisfy the demands of diverse users, we can offer various plug valve actuators such as manual, hand wheel, gear hydraulic, pneumatic and electric actuators.

Features

- SLETPETRO valve body are made from premium alloy steel, with special plating and heat treating process which greatly improve sealing capabilities, anti-abrasive and corrosive resistance.
- 10000 hours of artificial aging treatment on sealing arcing shim in superior toughness.
- The seals are vulcanized multiple times to get better sealing ability.
- The lightweight design enhances the maneuverability and reduce the labor intensity.

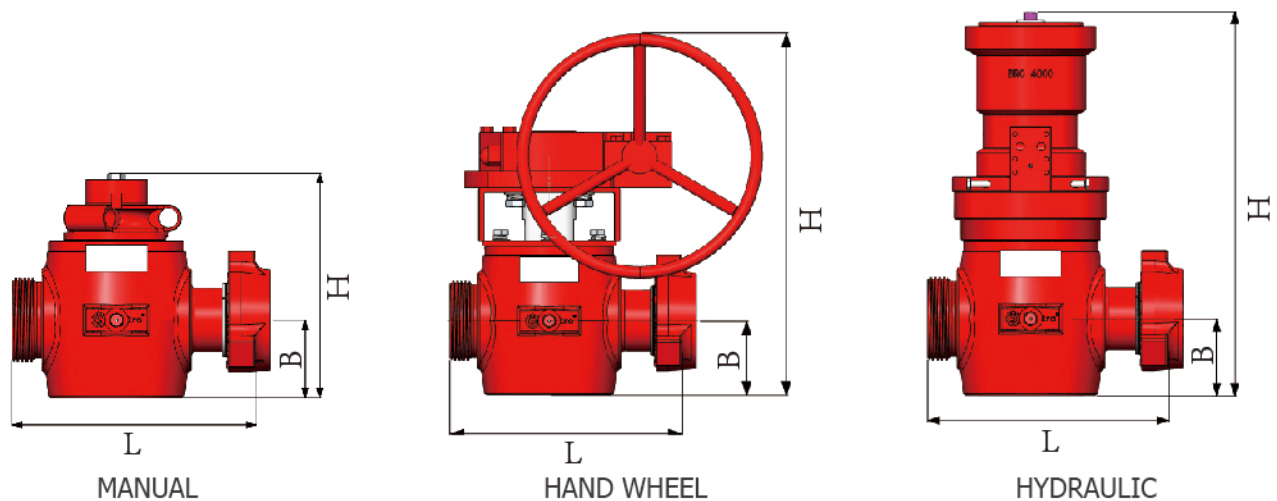

| Nominal Size | Sealings | End Connections | | Rated Working Pressure Mpa/Psi | Actuation | Dimensions(mm) | | | Service |
|--------------|-------------|-----------------|-----|-----------------------------------|------------|----------------|-----|-----|----------|
| | | | | | | L | B | H | |
| 1X2" | Single Seal | FIG1502 | FXM | 105/15000 | Manual | 269 | 61 | 185 | Standard |
| 1X2" | Single Seal | FIG1502 | FXM | 105/15000 | Hydraulic | 269 | 61 | 402 | Standard |
| 2" | Single Seal | FIG1502 | FXM | 105/15000 | Manual | 353 | 88 | 225 | Standard |
| 2" | Single Seal | FIG1502 | FXM | 105/15000 | Hydraulic | 353 | 88 | 433 | Standard |
| 2" | Dual Seals | FIG1502 | FXM | 105/15000 | Manual | 358 | 69 | 207 | Standard |
| 2X3" | Single Seal | FIG1502 | FXM | 105/15000 | Manual | 360 | 88 | 225 | Standard |
| 3" | Single Seal | FIG1502 | FXM | 105/15000 | Manual | 432 | 132 | 330 | Standard |
| 3" | Dual Seals | FIG1502 | FXM | 105/15000 | Manual | 398 | 127 | 366 | Standard |
| 3" | Dual Seals | FIG1502 | FXM | 105/15000 | Hand Wheel | 398 | 127 | 620 | Standard |
| 3" | Dual Seals | FIG1502 | FXM | 105/15000 | Hydraulic | 398 | 127 | 633 | Standard |
| 4" | Single Seal | FIG1502 | FXM | 105/15000 | Manual | 562 | 159 | 488 | Standard |
| 2" | Single Seal | FIG2002 | FXM | 140/20000 | Manual | 386 | 88 | 226 | Standard |
| 2" | Single Seal | FIG2002 | FXM | 140/20000 | Hydraulic | 386 | 88 | 433 | Standard |
| 3" | Dual Seals | FIG2002 | FXM | 140/20000 | Manual | 562 | 159 | 488 | Standard |
| 3" | Dual Seals | FIG2002 | FXM | 140/20000 | Hand Wheel | 562 | 159 | 771 | Standard |
| 3" | Dual Seals | FIG2002 | FXM | 140/20000 | Hydraulic | 562 | 159 | 710 | Standard |

Consult factory for special sizes, working pressure, end connections, or sour gas service.

1"~2" Plug Valves Repair Kit

1. Segment Seal rings I
Segment Seal rings II
2. Seal Segments
3. Side Segments
4. Plug
5. Backup-Rings I
6. O-Rings I
7. O-Rings II
8. Backup-Ring II
9. Grease Fitting

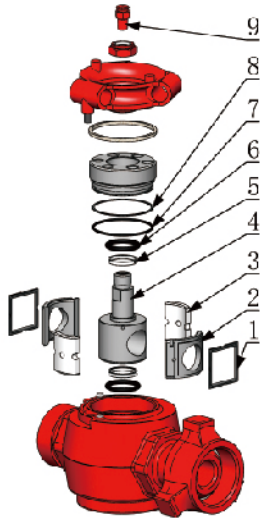

| Item | Descriptions | 1X2"-105 Single Seal | 2"-105 Single Seal | 2"-105 Dual Seals | 2"-140 Single Seal |
|------|-----------------------|-------------------------|-----------------------|----------------------|-----------------------|
| 1 | Segment Seal rings I | 2 | 2 | 2 | 2 |
| | Segment Seal rings II | - | - | 2 | - |
| 2 | Seal Segments | 2 | 2 | 2 | 2 |
| 3 | Side Segments | 2 | 2 | 2 | 2 |
| 4 | Plug | 1 | 1 | 1 | 1 |
| 5 | Backup-Rings I | 2 | 2 | 2 | 2 |
| 6 | O-Rings I | 2 | 2 | 2 | 2 |
| 7 | O-Rings II | 1 | 1 | 1 | 1 |
| 8 | Backup-Rings II | - | 1 | 1 | 1 |
| 9 | Grease Fitting | 1 | 1 | 1 | 2 |

3"~4" Plug Valves Repair Kit

1. Backup-Ring
2. O-ring
3. Seal Segments
4. Segment Seal rings I
5. Segment Seal rings II
6. Side Segments
7. Booster Springs
8. Plug
9. Backup-Rings I
10. O-rings I
11. O-ring II
12. Backup-Ring II
13. Grease Fitting

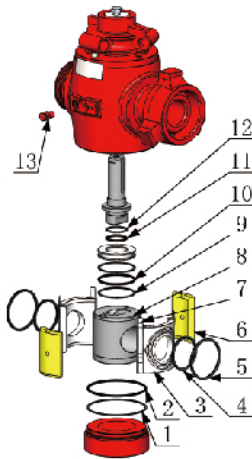

| Item | Descriptions | 3"-105 Single Seal | 3"-105 Dual Seals | 3"-140 Dual Seals | 4"-105 Single Seal |
|------|-----------------------|-----------------------|----------------------|----------------------|-----------------------|
| 1 | Backup-Ring | 1 | 1 | 1 | 1 |
| 2 | O-ring | 1 | 1 | 1 | 1 |
| 3 | Seal Segments | 2 | 2 | 2 | 2 |
| 4 | Segment Seal rings I | 2 | 2 | 2 | 2 |
| 5 | Segment Seal rings II | - | 2 | 2 | - |
| 6 | Side Segments | 2 | 2 | 2 | 2 |
| 7 | Booster Springs | - | 4 | 4 | 4 |
| 8 | Plug | 1 | 1 | 1 | 1 |
| 9 | Backup-Rings I | 2 | 2 | 1 | 1 |
| 10 | O-rings I | 2 | 1 | 1 | 1 |
| 11 | O-rings II | - | 1 | 1 | 1 |
| 12 | Backup-Ring II | - | 1 | 1 | 1 |
| 13 | Grease Fitting | 1 | 2 | 2 | 2 |